

#4
#3
#1
#2

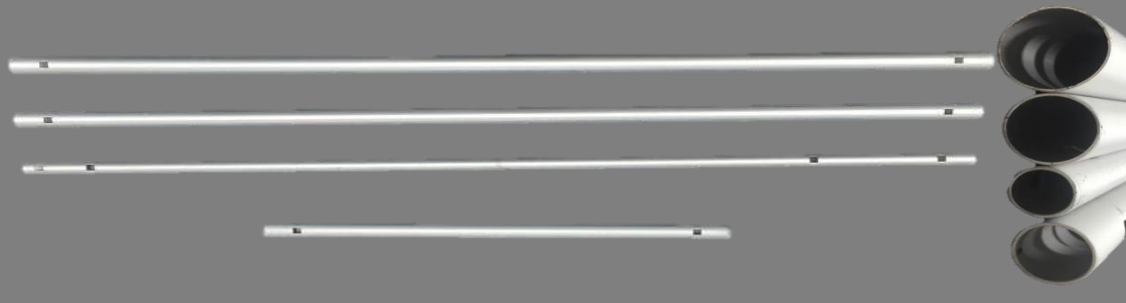

Solar Roller® Coverstick SINGLE ROLLER SYSTEM

TUBE LENGTH ASSEMBLY CHART

Tube ID Numbers

	#1	#2	#3	#4	#3	#2	#1	
				17.6'		**		18' Round
		**		16.5'		**		
				16.25'				15' Round
		**		16.1'		**		
				15.75'				12' Round or 12x24 Oval or 12x24 Inground
		**		15.6'		**		
<i>C</i>	<i>r</i>	<i>a</i>	<i>n</i>	<i>k</i>				15' Round
						**	14.75'	
<i>S</i>	<i>i</i>	<i>d</i>	<i>e</i>					10x20 Inground
					**	14.3'	**	
				13.25'				10x20 Inground
		**		12.8'		**		
				11.6'				
				11'				
		**		10'				
		**		9.5'				

** Means 3 tubes share a common hole

Add Tubes to lengthen Roller at this End.. from 4 to 7 tubes

#1-2 tubes slide to 4 positions

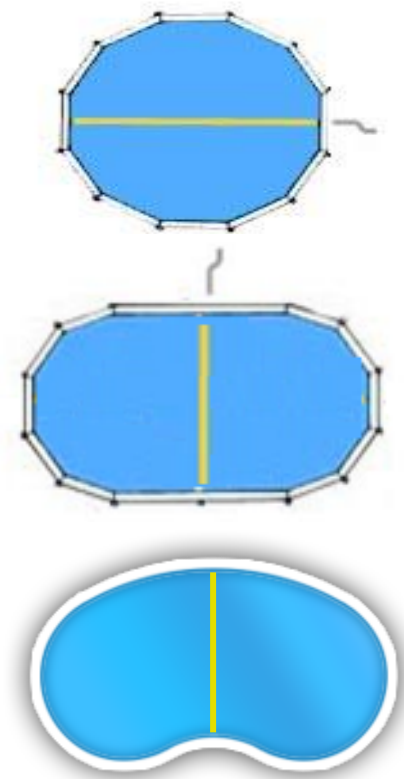
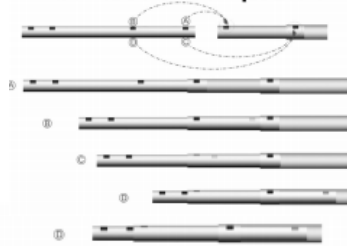
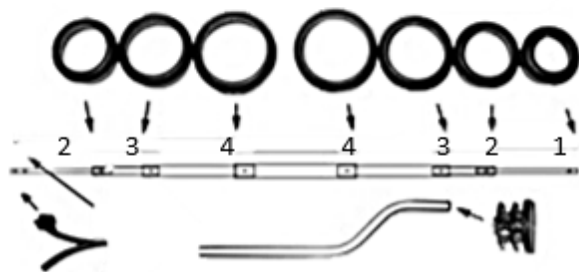

Chart not to scale

Tube lengths in inches





Endcaps, Spring buttons, & Endplugs



Fig 4 - Strap Connectors



Fig 5 - Edge Bushing & Spring Buttons

SOLAR BLANKET INSTALLATION

- LAY OUT COVER:** To install a solar blanket, lay the blanket out over the entire surface of the pool.
- SMOOTH OUT COVER:** Smooth out blanket and pull cover semi-taught along the entire pool edge so the cover is about 45 degrees off the water along the pool deck or walls.
- CUT COVER:** Now cut the cover like a cookie-cutter using the edge when rolling the cover.
- FINAL TRIM:** After cover has rested for a while you may need to trim any excess cover touching the wall as it settles.

ASSEMBLE ROLLER TUBES

- TUBE LENGTH ASSEMBLY CHART:** Use the Tube Length Assembly Chart to determine the tube combinations for your roller lengths. Unpack and LAY ALL TUBES OUT ON THE GROUND AS IN THE CHART. There are 4 tube diameter sizes (1-4) shown across the top of chart. The #1 tube has 4 holes: so from the crank-side, a button hole then edge bushing hole, then 2 holes on the connector end for adjustments. The shorter #2 tube can be completely hidden in some configurations, but must be used or you'd have a gap between #1 and #3 tube diameters.
- INSTALL COLLARS:** See "Endcaps, Spring buttons, & Endplugs" for location of end collars that are tapped onto tubes and plugs for crank handle. **WARNING: DO NOT push collars/plugs on with your hands.** Place collar/plug on tube end and tap or press collar/plug/tube on the ground to install part.
- CONNECT TUBES:** Using the chart on the backside, line up common holes and interconnect tubes by inserting the improved zip-locking strap connectors. Pull tightly to cinch zip-tie down until fully tight.
- INSERT EDGE BUSHINGS:** Both ends of rollers always get bushings for attaching the edge of the cover, whereas only the cranking end gets the spring button to engage the crank. The edge holes are NOT tube connecting holes, they are for attaching the edges of cover. SO for each assembled roller, insert a small bushing (in same bag as fasteners) into the second hole on the crank side (FIG 5), and another bushing into the final hole at the far end of the assembled roller. Because we recently upgraded our product to use the improved strap connectors, there are lots of extra bushings.

Additional help and photos available online at

www.solarfactory.com

- INSERT SPRING BUTTONS:** For the removable crank to engage, insert a spring button into the first hole of the #1 tube (NOT THE CRANK) with protective tip extending out which prevents tube from touching the wall (FIG 5). Be sure you installed an edge bushing into the empty second hole to receive edge fasteners for covers.

ATTACH ROLLERS TO COVER

- INSERT ROLLER:** Remove and fold your blanket in half (bubbles inside) and slide the built pole down the crease to ensure bubble side is attached to pole. **NOTE: Crank handle must be inset 1" from the solar cover edge, no more, no less.** This will ensure you can get the crank spring button when cover is rolled, and allows cover to bumper the tube end. Do not allow tubes to extend beyond the ends of the cover.
- SMOOTH FOLD:** Smooth out the cover along the roller so there are no wrinkles when you fasten the cover to the rollers. Pinch the cover around the roller smoothing it taught as you smooth down the tube with your hand. Don't raise the roller off the ground; work on ground level to ensure NO BOWING.
- ATTACH COVER:** After ensuring the cover is smoothed along the roller, insert the pronged fasteners penetrating the prong through the cover into the edge bushing and the tube connector holes. Small punctures do not hurt the cover. The tapered prongs are designed to expand the receiving hole as you turn head 180° and lock fastener head in line with the tube. Push firmly down feeling the click as the fasteners turn/lock into place. If difficult, DO NOT OVER TWIST, just simply push down more.
- REPLACE BLANKET:** Ensure bubbles and pole are face down.

OPERATING THE SYSTEM

- CRANK GENTLY:** Do not over crank. Build rolling momentum.
- DRAIN COMPLETELY:** Always allow the heavy water to completely drain from end of roll (min 30 seconds) or you will bend the tubes. The roll should weigh 30 lbs or less. If the roll weighs more than 30 lbs, water is trapped in blanket and more draining is required.
- DO NOT CARRY LIKE A SUITCASE:** To prevent bending tubes, balance the load in both hands at shoulder width.
- STORE BLANKET IN SAFE AREA**